

견적 요청

두 가지 견적을 요청드립니다

	견적 1	견적 2
L-FRAME_SUS	x 2	x 16
BAR_SUS	x 1	x 6
FRAME_PART1_AL	x 4	x 16
FRAME_PART2_AL	x 4	x 16
TOP_SUS	x 0	x 1
BOTTOM_SUS	x 0	x 1

L-FRAME_SUS

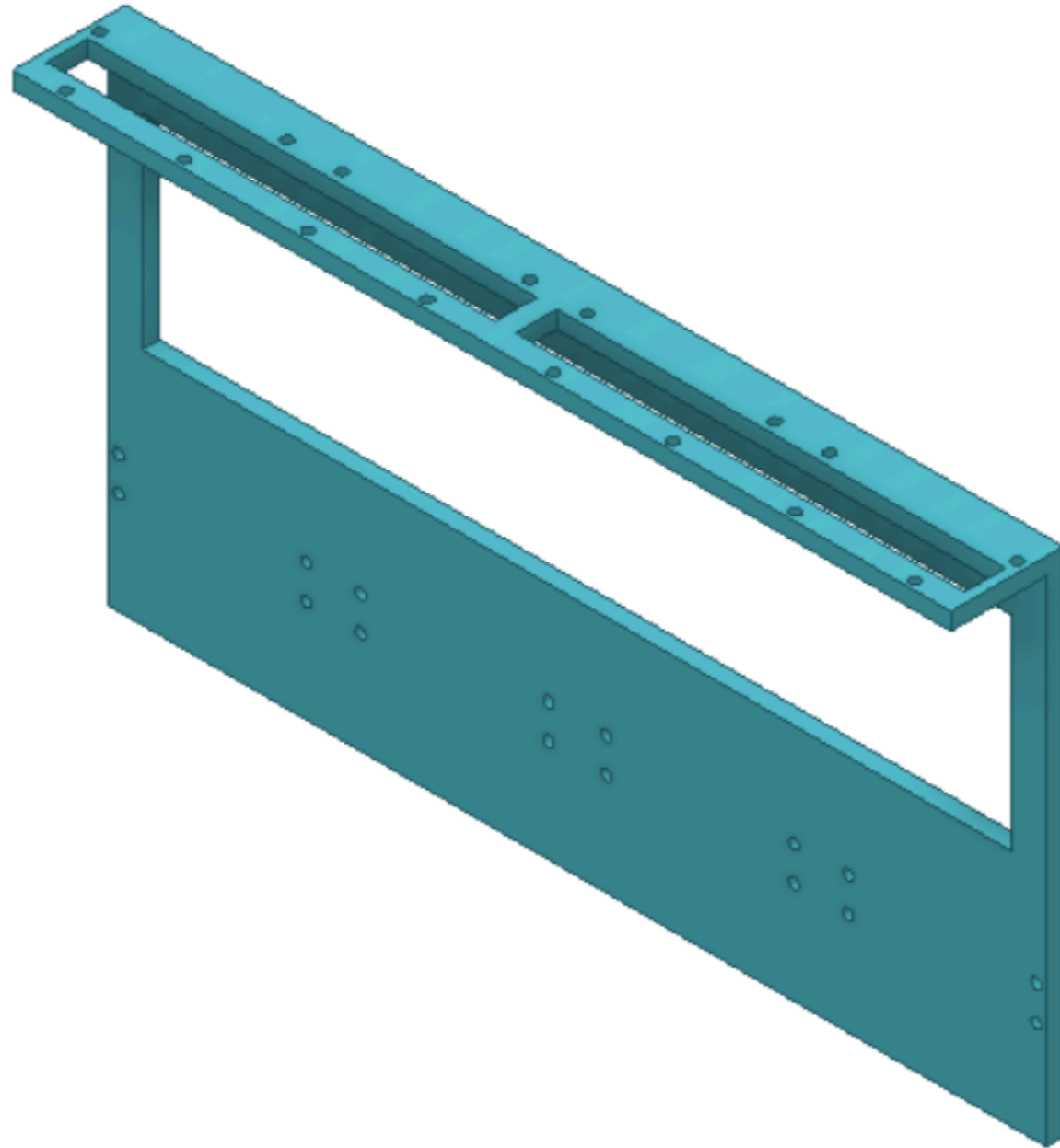

두께 : 5T 재질 : SUS

모든 구멍은 나사선이 없음
M3 나사가 통과

BAR_SUS

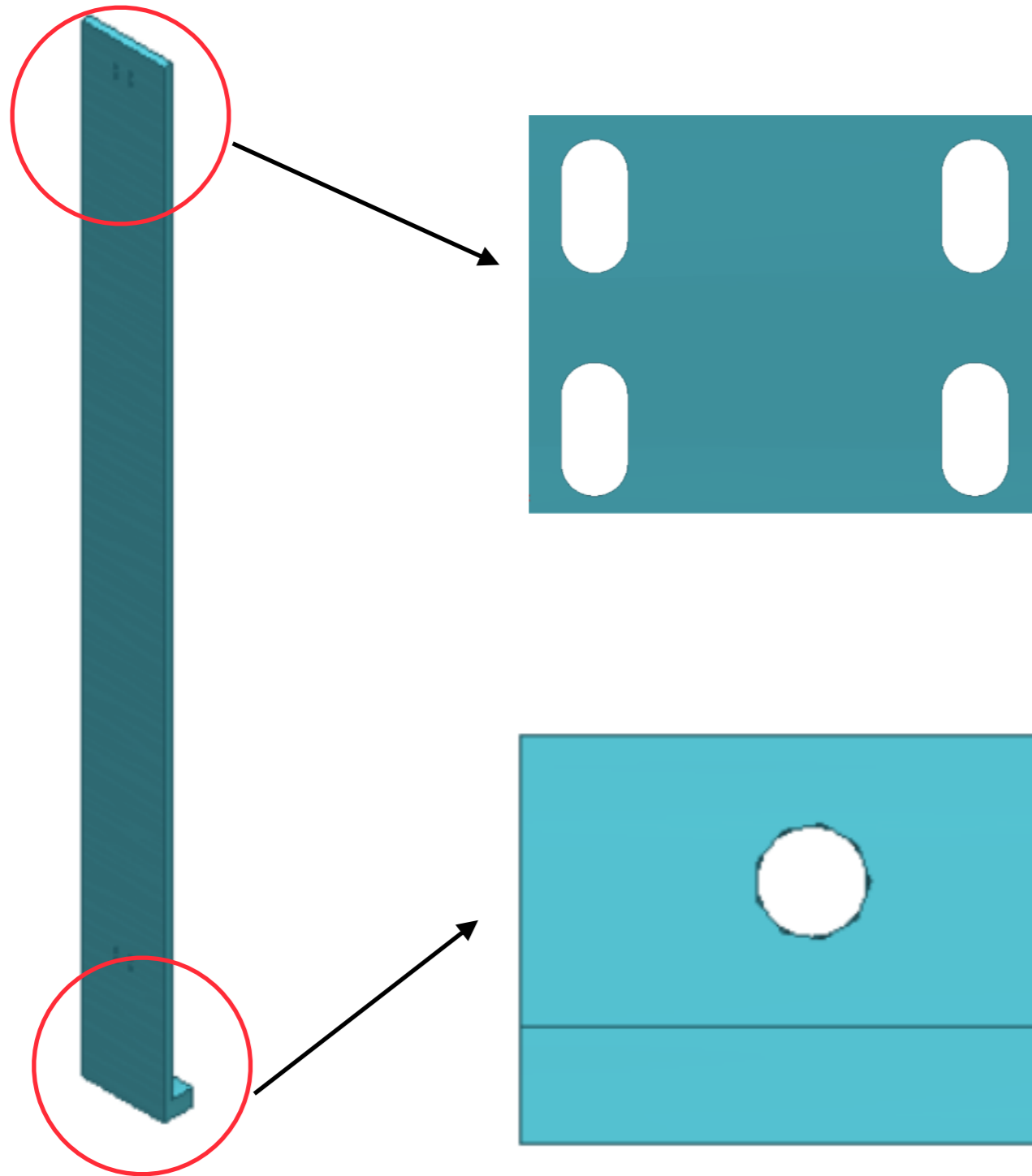

두께 : 10T

재질 : SUS

벽면 구멍은 나사선이 없음
M3 나사가 통과

바닥 구멍은 M10 나사 구멍

FRAME_PART1_AL

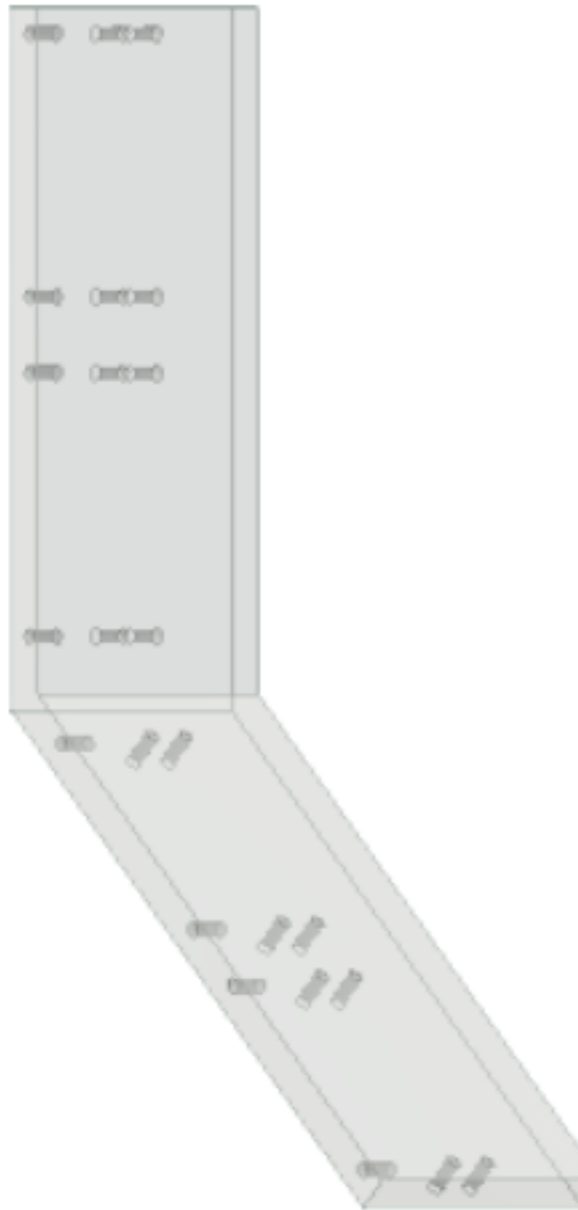

두께 : 8T

재질 : 알루미늄

모두 M3 나사 구멍

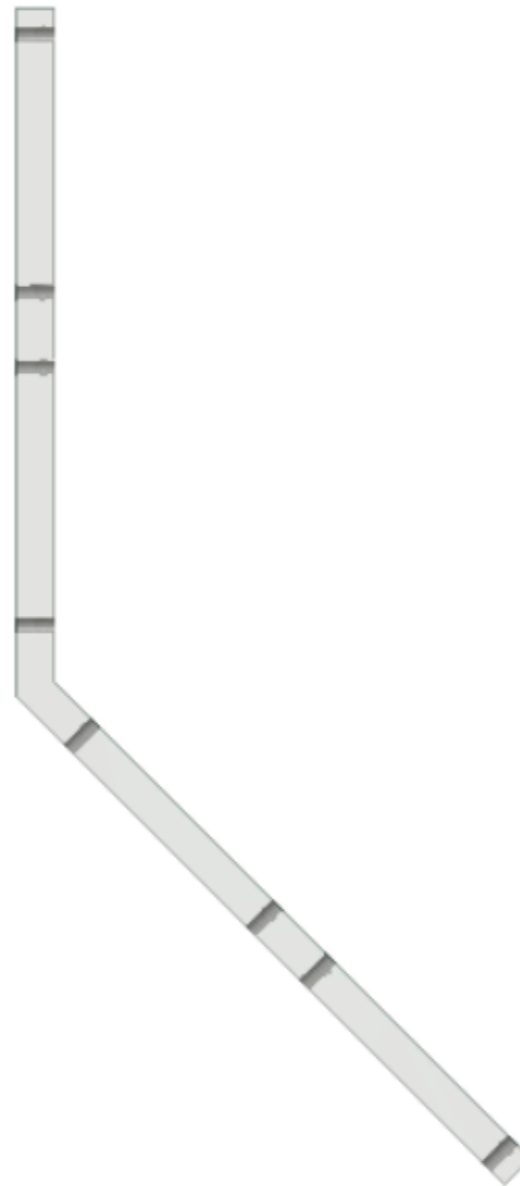

FRAME_PART2_AL

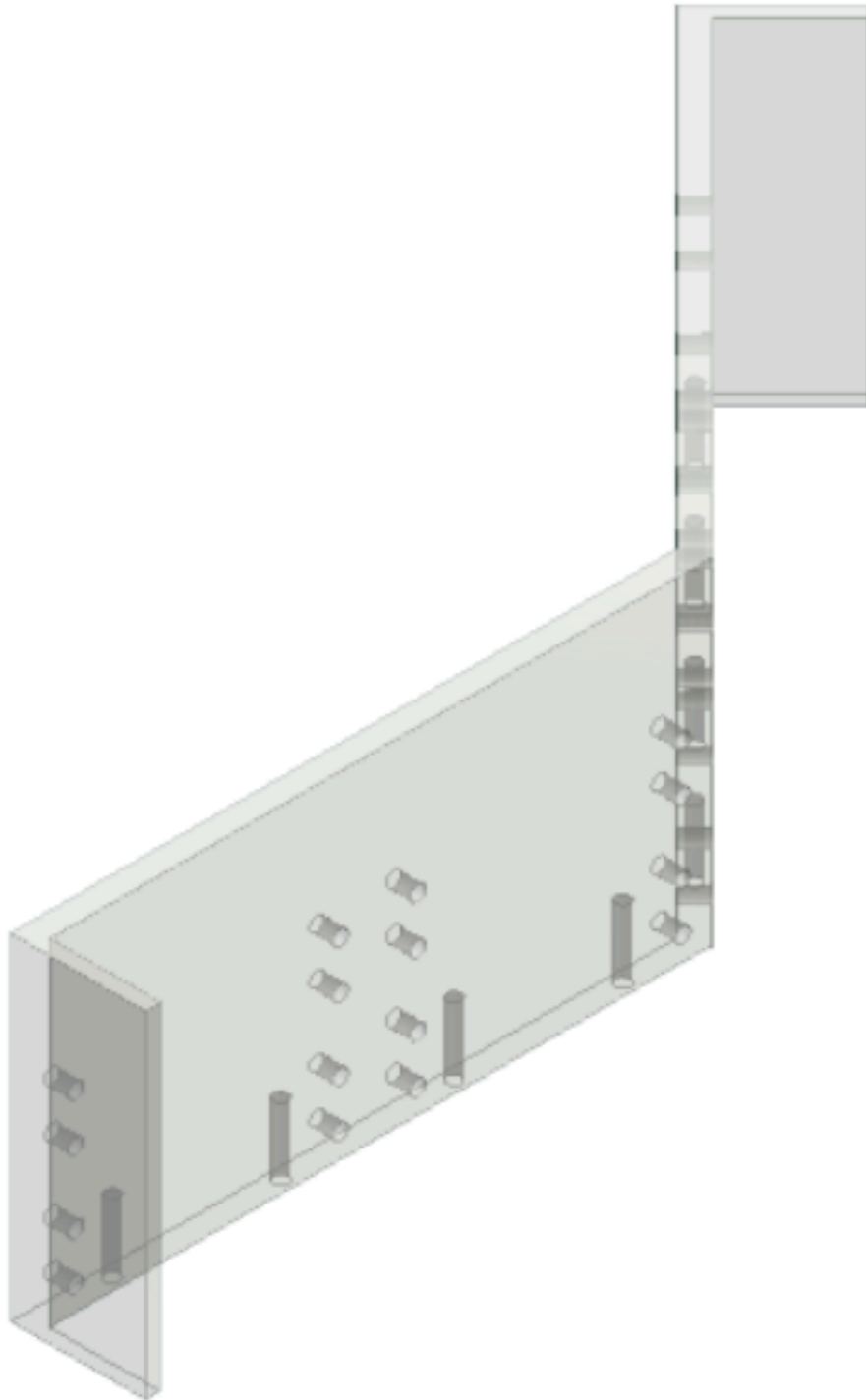

두께 : 몸통 5T 옆면 3T 재질 : 알루미늄

모두 M3 나사 구멍

TOP_SUS

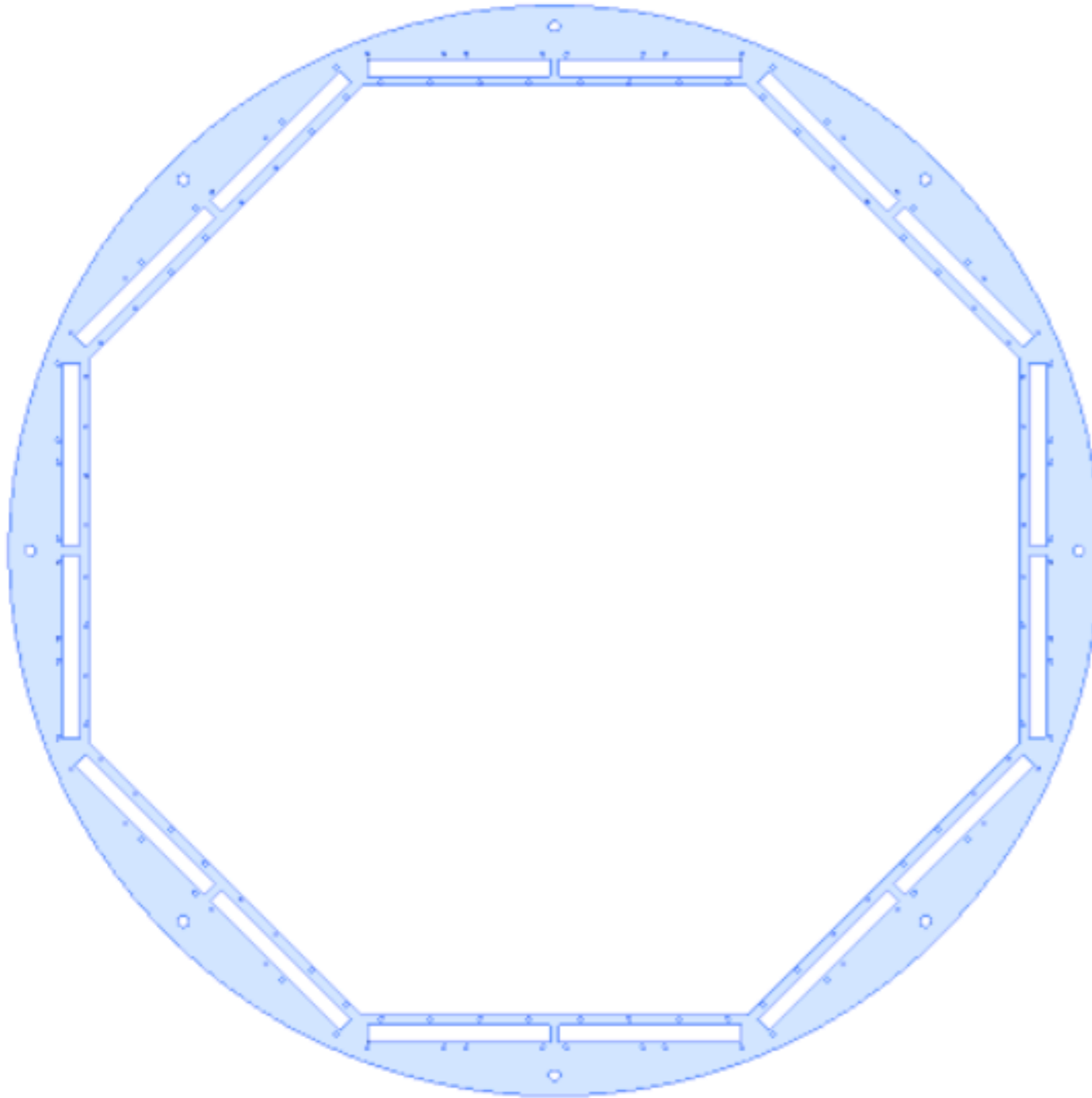

두께 : 10T 재질 : SUS

바깥쪽 M8 나사 구멍 8개
안쪽은 모두 M3

BOTTOM_SUS

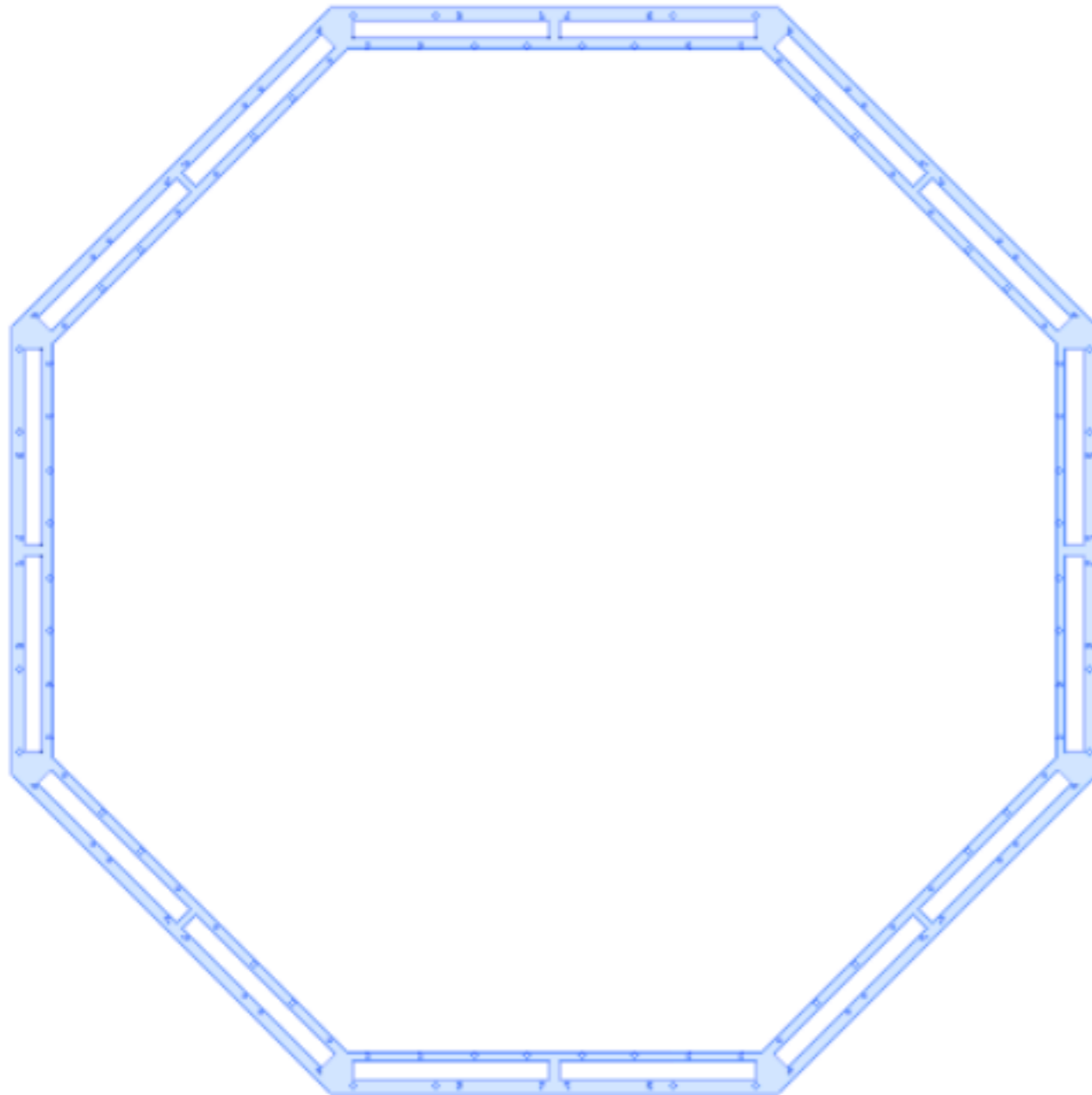

두께 : 10T 재질 : SUS

모두 M3 나사 구멍